

Financial Dashboard

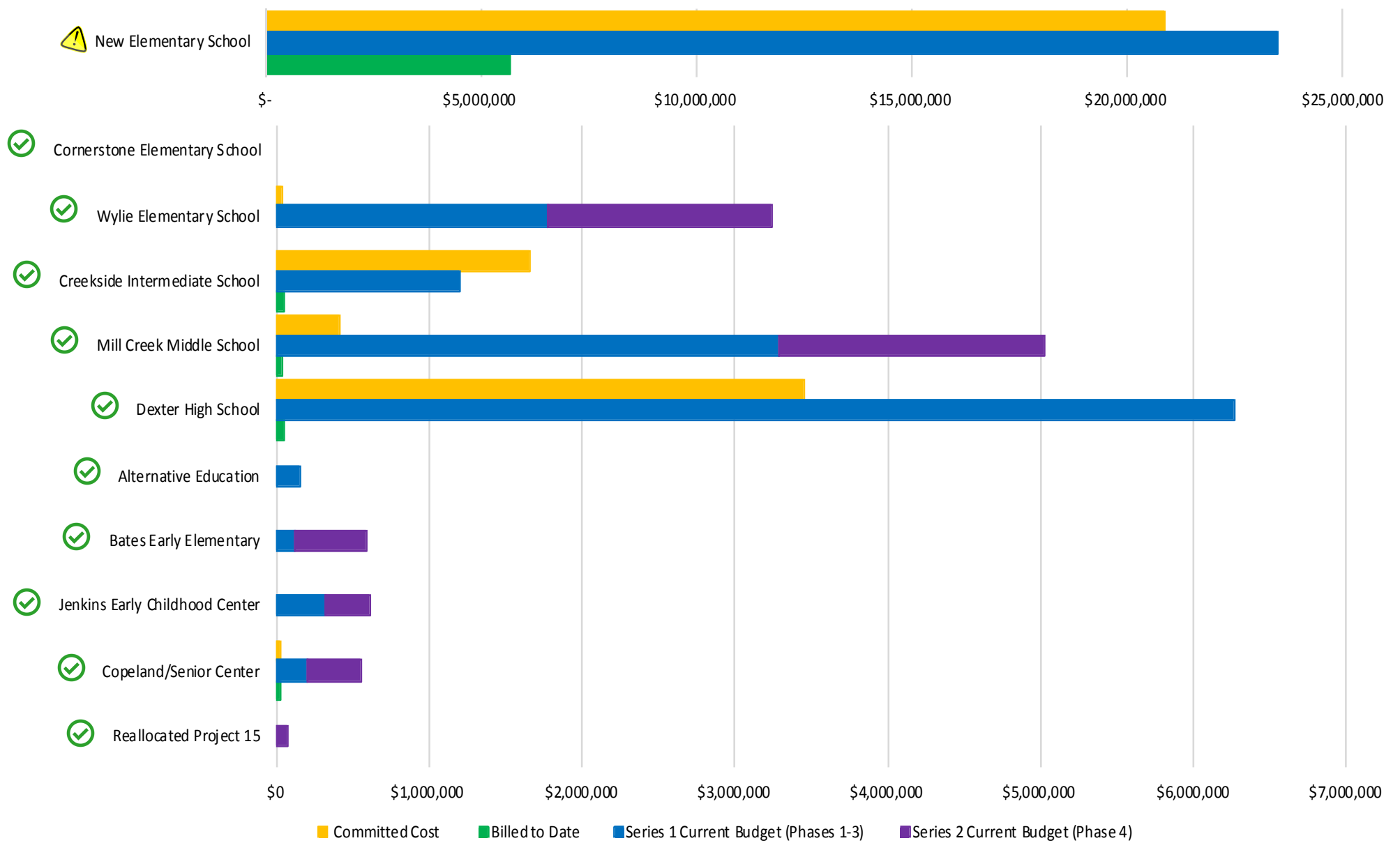

		Series 1 (Phases 1-3)					
Description of Work	Total Original Budget	Original Budget	Budget Revisions	Current Budget (Col 1 + 2)	Pending and Committed Project Cost	Variance from Current Budget (Col 3-4) Surplus/(Deficit)	
Construction Costs							
Project #01: New Elementary School	\$ 21,871,604	\$ 23,500,585	\$ -	\$ 23,500,585	\$ 23,500,585	\$ -	
Project #02: Cornerstone Elementary School	\$ 1,628,981	<i>CES (Project #2) was combined into NES (Project #1) above</i>					
Project #03: Wylie Elementary School	\$ 3,236,902	\$ 1,780,799	\$ -	\$ 1,780,799	\$ 1,780,799	\$ -	
Project #04: Creekside Intermediate School	\$ 4,498,653	\$ 1,195,813	\$ -	\$ 1,195,813	\$ 1,195,813	\$ -	
Project #05: Mill Creek Middle School	\$ 5,024,640	\$ 3,292,280	\$ -	\$ 3,292,280	\$ 3,292,280	\$ -	
Project #06: Dexter High School	\$ 8,710,776	\$ 6,266,605	\$ -	\$ 6,266,605	\$ 6,266,605	\$ -	
Project #07: Alternative Education	\$ 158,258	\$ 158,258	\$ -	\$ 158,258	\$ 158,258	\$ -	
Project #08: Bates Early Elementary	\$ 586,113	\$ 118,323	\$ -	\$ 118,323	\$ 118,323	\$ -	
Project #09: Jenkins Early Childhood Center	\$ 616,713	\$ 319,422	\$ -	\$ 319,422	\$ 319,422	\$ -	
Project #10: Copeland/Senior Center	\$ 552,422	\$ 209,039	\$ -	\$ 209,039	\$ 209,039	\$ -	
Projects #11-15	\$ 135,270	\$ 65,635	\$ -	\$ 65,635	\$ 65,635	\$ -	
CM General Conditions Costs	\$ 912,158	\$ 716,690	\$ -	\$ 716,690	\$ 716,690	\$ -	
Construction Manager Services	\$ 2,966,611	\$ 2,330,891	\$ -	\$ 2,330,891	\$ 2,330,891	\$ -	
SUBTOTAL CM Responsibility	\$ 50,899,101	\$ 39,954,340	\$ -	\$ 39,954,340	\$ 39,954,340	\$ -	
Project #07: Alternative Education (Owner Man	\$ 633,496	\$ 633,496	\$ -	\$ 633,496	\$ 37,996	\$ 595,500	
TOTAL 2017 Bond Construction Project Costs	\$ 51,532,597	\$ 40,587,836	\$ -	\$ 40,587,836	\$ 39,992,336	\$ 595,500	
Project #6: Dexter High School Fields Work (fr	\$ 600,000	\$ 600,000	\$ -	\$ 600,000	\$ 600,000	\$ -	
TOTAL Construction Project Costs	\$ 52,132,597	\$ 41,187,836	\$ -	\$ 41,187,836	\$ 40,592,336	\$ 595,500	

Amounts are through June 2018 billing.

Series 2 work is anticipated to start in 2022 and reporting will be shown at that time.

Active Projects Status

Building	Target Dates		Status
	Start	Finish	
New Elementary School	11-2017	12-2018	✔ Work progressing on schedule.
Dan Hoey Road Work	6-2018	8-2018	✔ Work progressing on schedule.
High School Twin Turf Fields	5-2018	8-2018	⚠ Waiting for County SESC* permit.
Creekside Roundabout 4 th Leg	6-2018	8-2018	⚠ Waiting for County SESC* permit.
Mill Creek Special Ed Remodel	6-2018	8-2018	✔ Work progressing on schedule.
Cornerstone Parking Lot	6-2018	9-2018	✔ Work progressing on schedule.
Creekside Quad Softball Fields	7-2018	10-2018	✔ County SESC* temporary permit received.

**soil erosion and sedimentation control*

New Elementary School

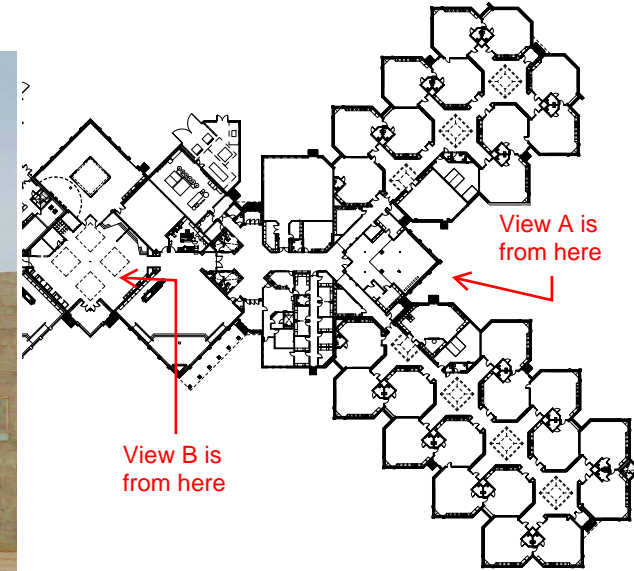

The brick facing has been removed from Cornerstone where the new construction will be attached.



Mill Creek Middle School Special Education

Demolition has progressed rapidly.

